



ENGLISH



<i>Manufacturer</i>	GHIDINI BENVENUTO s.r.l.
<i>Product</i>	Ironing unit PUFFER
<i>Year</i>	2004
<i>Certification</i>	

CONTENTS

1	INTRODUCTION	10	HAZARDOUS USE
2	GENERAL DESCRIPTION	11	OVERALL DIMENSIONS AND DRAWINGS
3	MACHINE IDENTIFICATION	12	MAINTENANCE PROCEDURES
4	TECHNICAL FEATURES	13	DISPOSAL
5	MACHINE COMPONENTS	14	HOW TO ORDER SPARE PARTS
6	MACHINE UNPACKING AND INSTALLATION	15	HANDLING AND TRANSPORT
7	INSTRUCTIONS FOR USE	16	WARRANTY
8	TROUBLESHOOTING AND SOLVING	17	CONFORMITY DECLARATION
9	PRECAUTIONS		

1 INTRODUCTION

The present user's and maintenance manual refers to the ironing unit Puffer.
It is possible to receive the latest release from our Technical Commercial Department or by visiting our website www.ghidini-gb.it. The present user's and maintenance manual contains important information for the operator's health safeguard and safety.

This manual has to be read and kept carefully, in order to be always at the operator's disposal in case of need. Ghidini s.r.l. cannot be held liable for any damage to things or injury to persons caused by improper use of the machine in contrast with these instructions.

Any possible modifications effected on the components of the machine or its different use without prior written authorization by Ghidini s.r.l., relieve the latter of injury to persons and / or damages to things, voiding any warranty bindings, as well.

2 GENERAL DESCRIPTION

The ironing unit Puffer is designed to touch up some parts of the garment, like shoulders, sleeves, armholes. This unit requires an external steam supply for its operation.

The unit is very user-friendly and efficient thanks to the operation controlled by a front pedal.
It features a broad working surface with three different up-steaming shapes for all the difficult parts to be ironed (mod. 3). Besides the combined version featuring three different shapes, the single-shape version is also available (mod. P, S, and B).

3 MACHINE IDENTIFICATION

A tag placed on the rear side of the machine indicates type, serial number, year of construction and the supply voltage of the same.

4 TECHNICAL FEATURES

TECHNICAL FEATURES	
Steam supply	5 bar min. - 6 bar max.
Steam working pressure	5 bar
Power consumption	10÷12 Kg/h
Sound intensity level	< 70 dB(A)
Sound intensity level	+ 5 ÷ + 80 °C
Working humidity	90 % max.
Storing temperature	- 20 ÷ + 50 °C
Net dimensions Puffer P-S	350 x 400x1100 mm
Net dimensions Puffer B	690x550x1100 mm
Net dimensions Puffer 3	1300x550x1100 mm
Net weight	(Puffer S,P,B - 26 Kg) (Puffer 3 - 55Kg)
Overall dimensions (packaging included)	(Puffer S,P,B - 670x470x1150) (Puffer 3 - 1750x700x1250)
Gross weight (packaging included)	(Puffer S,P,B - 35 Kg) (Puffer 3 - 80Kg)

WARNING: The machine must not be supplied with different pressures than those indicated on the table.

5 MACHINE COMPONENTS

Main components of the machine:

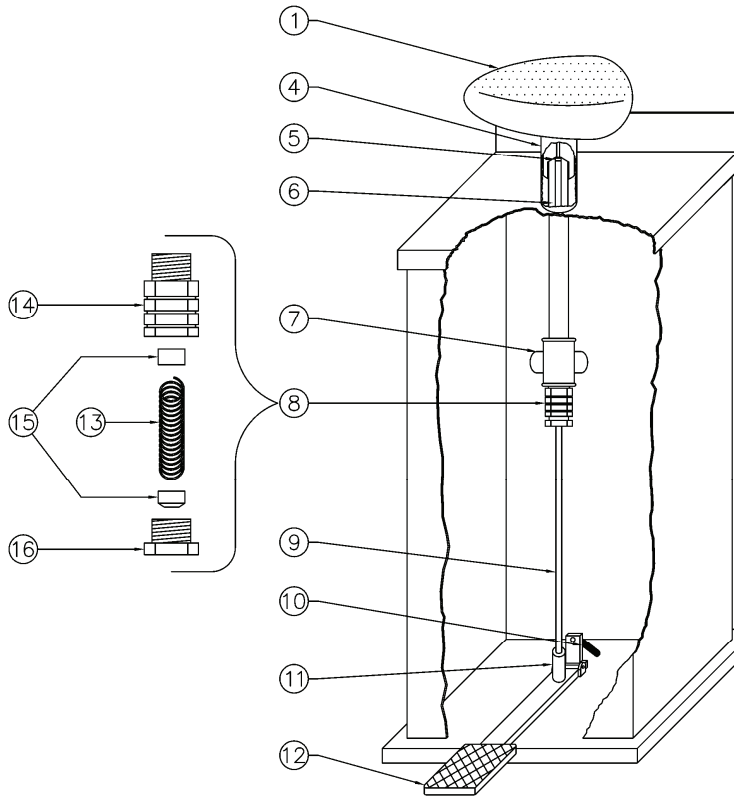

Pos.	ARTICLE	DESCRIPTION
1	880000	Shoulder shape
2	880002	Egg shape
3	880001	Sleeve shape
4	46N018	Insulating sheathing
5	880118	Cut-off
6	880044	Plate and tube 3/4 mod. P-S-B
	880120	Plate and tubes 3/4 mod. 3
7	880047	Tee 3/4 + 36A012
8	880119	Complete valve
9	880050	Cut-off rod
10	880056	Spring
11	35I001	Fork
12	880055	Pedal cover
13	880053	Spring
14	880051	Valve
15	880048	Supporting hub
16	880052	Valve cap
17	880122	Nipple connector 3/4
18	880121	Tube 3/4
19	880047	Cross fitting 3/4

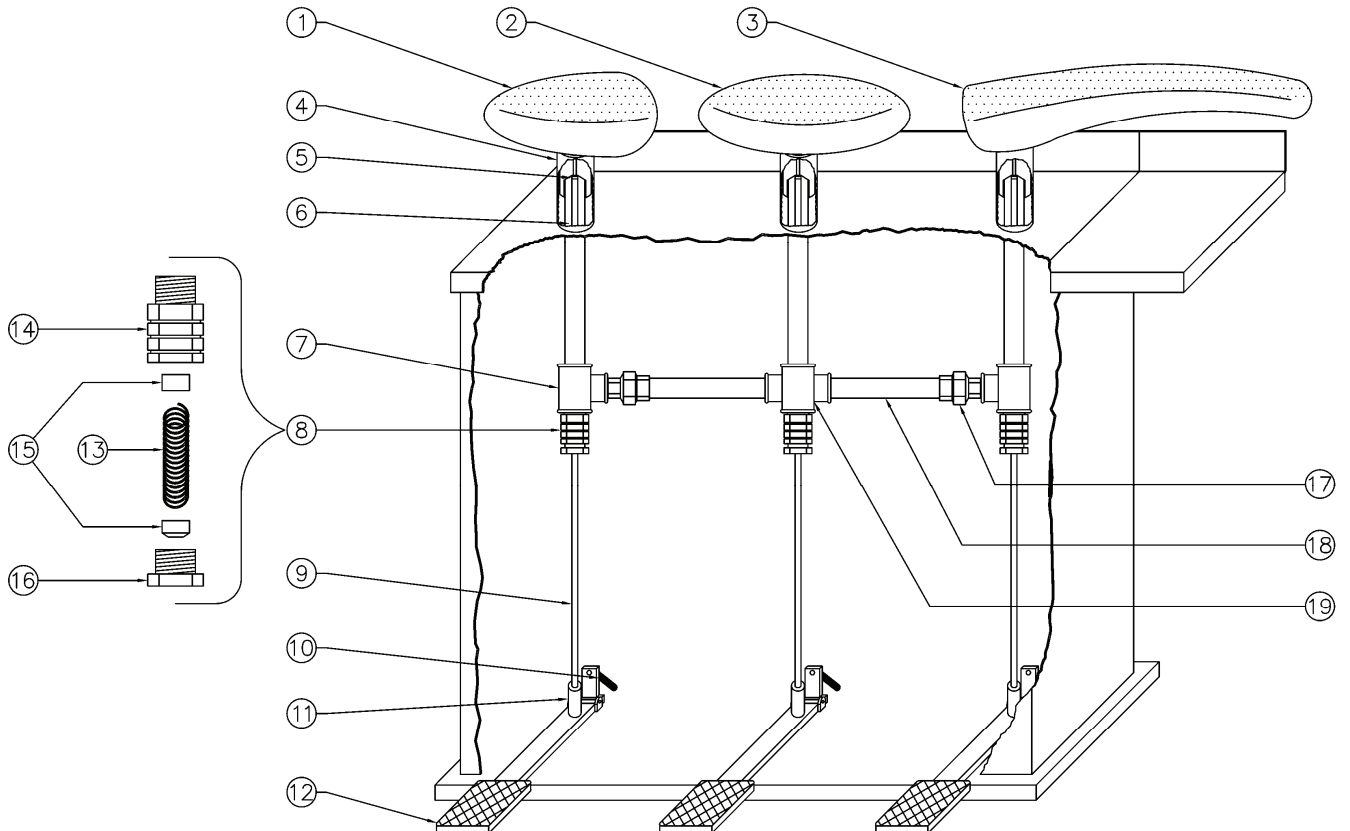

6 MACHINE UNPACKING AND INSTALLATION

WARNING: The unit must be installed, opened and repaired by fully qualified technicians only.

6.1 UNPACKING

Find the most suitable place where to put the machine, then remove the packaging. Make sure that the machine has not been damaged during the transport and the storage.

The packaging material does not require any special precautions for its disposal, for it is not dangerous or polluting at all. Please refer to the local regulations for its disposal.

6.2 MACHINE INSTALLATION

The machine has not to be anchored to the floor, except for the installation on means of transport. Use the specially designed holes on the bedplate for its correct fixing.

In order to guarantee a correct use and operation, as well as an easy maintenance, leave enough free space around the machine

Do not place the machine in dangerous and/or explosive/inflammable places.

6.3 ELECTRICAL WIRING

The unit doesn't require any electrical wiring.

If the machine is placed near electric equipments or control boards, it is compulsory to earth the machine body, even if the same is not supplied with power.

6.4 STEAM SUPPLY CONNECTION

- In case of a connection to a **central steam supply**, proceed as follows:

Connect a pipe with a G 3/8" gas threading to the top part of the steam outlet of the central unit and place an on-off-valve close to the machine. Afterwards, connect a pipe with an internal diameter of at least 10 mm to the steam intake (G 3/8" gas threading) of the machine. For the condensation return (G 3/8" gas threading), provide a pipe with exactly the same features of the steam pipe and install near the machine a condensation discharge with filter, as well as an on-off-valve followed by a check valve. For the connection to the check valve, use a pipe with an internal diameter of at least 10 mm. The steam pressure inside the piping must be of max. 6 bar.

- In case of a connection to a **small steam generator**, proceed as follows:

The steam intake of the machine with a G 3/8" threading for the connection to the steam generator is placed on the back of the machine. The steam network pressure must be of max. 6 bar.

It is advisable to install a pipe having an internal Ø of at least 10 mm. Install an on-off valve on the piping in order to exclude the machine from the steam generator. Connect the condensation return to the machine (with a G 3/8" threading), by using also in this case a pipe with an internal Ø of at least 10 mm. Install on this piping a check-valve and an on-off valve, in order to exclude the machine from the installation. Connect eventually to the small steam generator.

Do not bend the pipes at right angles, but at least with a 50 mm radius. Make sure that the pipes have an even incline, especially the one for the condensation return.

Do not use traps, fittings or gate valves with a smaller diameter than the pipe, itself. The piping must not exceed 2.5 meters. The hole of the condensation return has to be at least 150 mm higher than the water level inside the boiler.

WARNING: After having carried out all the connections, make sure that pipes and cables are protected against any possible hits and are suitably fixed and isolated.

7 INSTRUCTIONS FOR USE

7.1 PUTTING INTO OPERATION

- The whole unit can be used, opened and repaired by qualified technicians only.
- It is forbidden to use the machine if flooded by liquids or in particularly aggressive or explosive/inflammable places.
- Do not ignore the dangers for the operator's health and follow the hygienic and safety regulations.
- Always use suitable pipes according to the working pressure.
- Fit the up-steaming shapes (disassembled to the shipment) by using the supplied screws.

7.2 PRELIMINARY STEPS BEFORE EACH PUTTING INTO OPERATION

- Check if the machine is intact.
- Check the connection to the steam piping.
- Once the unit is connected, you have only to press on the steam pedals. Prior to this operation, always check that the steam valves are open.

- Check if the steam circuit has reached the necessary working pressure, by pressing repeatedly the relevant pedals.
- Especially in case of a connection to a small steam generator, some condensation may come out at the beginning. Pressing the steam pedals repeatedly will facilitate a quicker steam discharge.
- If the machine is new or has not been used for a long time, it is advisable to carry out some ironing cycles without garments.

7.3 REGULATIONS

- The only regulation to be carried out is the correct positioning of the up-steaming shapes.

7.4 USE

- Place the garment part to be ironed on the relevant shape.
- The garment part must accurately fit onto the shape.
- Keep the relevant steam pedal pressed until the garment part is properly ironed.

Pay attention to the danger of burns during these operations.

8 TROUBLESHOOTING AND SOLVING

The following diagnostic table indicates the main irregularities which can occur, their probable causes and possible solutions

In case of doubts and/or of problems, which can't be solved, do not attempt to disassemble parts of the machine for the troubleshooting, but contact our Technical Department or the Ghidini-reseller, instead.

DIAGNOSTIC TABLE		
PROBLEMS	POSSIBLE CAUSES	SOLUTIONS
No steam supply	Steam intake closet	<i>Open the valve of the steam intake</i>
	Steam valve blocked	<i>Replace the valve with a new one</i>

9 PRECAUTIONS

Read carefully the instructions and the risks related to the use of a spotting table. The operator has to know its working functions and must clearly understand its dangers with the help of the manual.

Main electrical supply

No electrical wiring required.

If the machine is placed near electric equipments or control boards, it is compulsory to earth the machine body, even if the same is not supplied with power.

Inflammability

Adopt all the necessary precautions to avoid any direct contact of the machine with hot materials or flames. Put fire extinguishers near the machine for an immediate intervention in event of fire.

Pressure / Steam

Prior to any intervention, close the valves of both steam supply and discharge, and check that there are no residual pressures inside any branch of the hydraulic circuit, as they could cause steam spurts, in case of disassembly of fittings or other components.

Noise

The machine's noise level is not very high, as it remains under 70dB (A).

10 HAZARDOUS USE

The conformity verification according to the essential safety rules and to the provisions of the machine directive has already been carried out by filling out the specially provided checking lists, included in the technical file.

The checking lists are of two kinds:

- List of dangers (drawn from EN 1050 referring to EN 292)
- Application of the main safety features (Machine Directive— appendix. 1, part 1)

The dangers described in the following have not been completely removed, but they have been deemed to be acceptable:

- During the maintenance operation there could be some steam jets at low pressure, (maintenance operation must therefore be carried out by using suitable protection devices).
- The user must provide for a protection against direct and indirect contacts.

11 OVERALL DIMENSIONS AND DRAWINGS

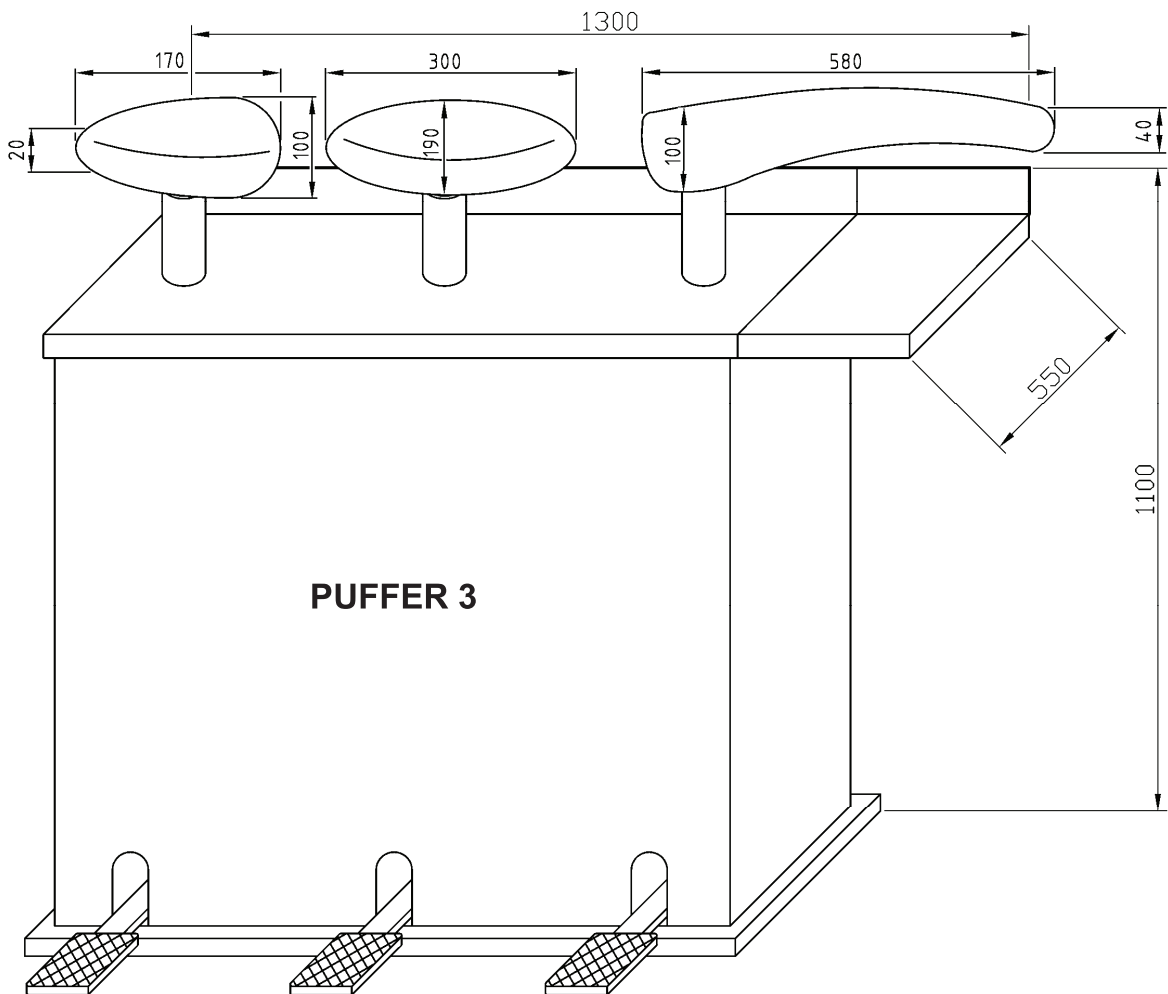
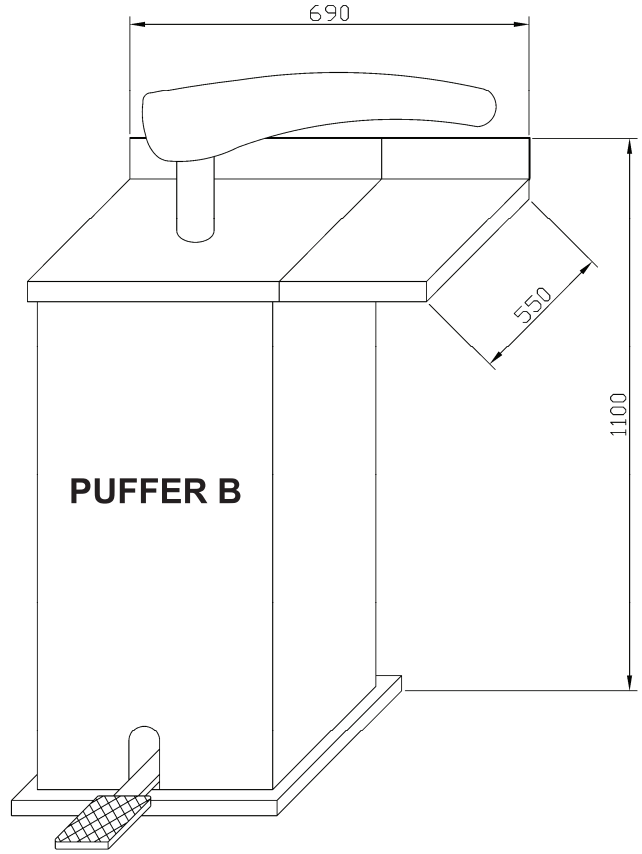
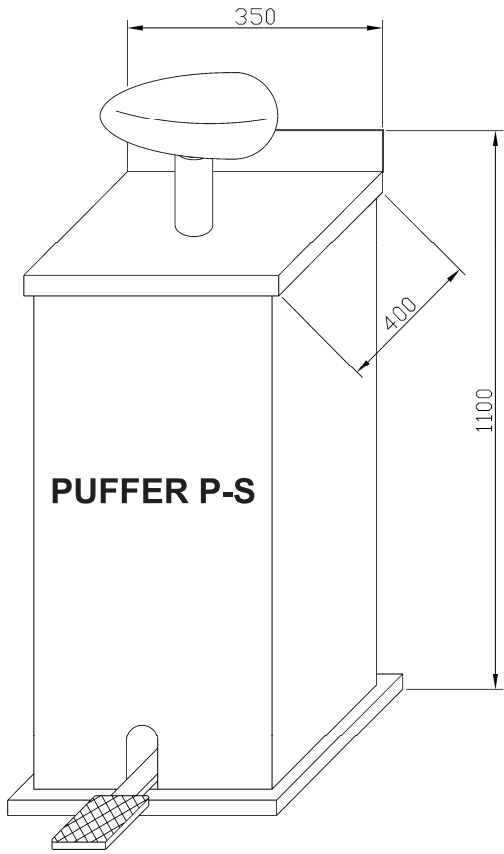

12 MAINTENANCE PROCEDURES

The unit doesn't require any ordinary maintenance. In case of irregularities or malfunctioning, please contact the service technician for the relevant checks.

Periodically, it is necessary to carry out the following operations:

OPERATION	WORKING HOURS
Check the tightness of the steam unit	200

This machine does not require special equipment for check and/or maintenance operations. It is however advisable to use suitable tools and personal protections in compliance with the Italian law by decree 626/94, which have to be in good conditions (Presidential Decree 547/55), in order to avoid any damages to persons or machine components.

Make sure that the hydraulic system is disconnected prior to any maintenance service.

13 DISPOSAL

During the maintenance on the machine, or in case of its scrapping, please dispose carefully and correctly of any polluting components, according to the local regulations. In case of scrapping, the identification rating plate and any other document have to be destroyed.

14 HOW TO ORDER SPARE PARTS

Upon the spare parts request, please quote always:

Machine type, serial number, quantity of the requested spare parts, article number (these data can be read on the rating plate or supplied by the technical information of the machine and by the user's and maintenance manual). The technical data, the descriptions, and pictures included in this manual are not binding.

The manufacturer reserves the right to make any necessary modification without notice or having to up-date the present manual.

15 HANDLING AND TRANSPORT

Before its shipment, the machine is carefully packed. During the shipment and storing of the machine, pay particular attention to the upside indication on the packaging (wooden crate or pressed cardboard). Upon receipt, please check that the packing is intact and store the machine in a dry place.

16 WARRANTY

All Ghidini products are guaranteed for a maximum period of 12 months from delivery date as far as material and construction defects are concerned.

The warranty is extended as follows:

In case of malfunction of the equipment, please contact your Ghidini reseller, specifying the noticed defect, type, serial number and furthermore the operating conditions of the machine. After having received the equipment or component and after an accurate analysis, Ghidini reserves the right, whether to repair or to replace the product. If the machine is still under guarantee, the Ghidini reseller will carry out the service or replacement at Ghidini's charge. In case the returned goods are not defective, Ghidini reserves the right to charge the customer with the met expenses (shipment, etc.). The present warranty will be declared void, if the machine has been damaged due to improper use, negligence, normal wear, chemical corrosion, installation not according to the provided instructions and to the manufacturer's warnings.

Any modification, tampering and alteration on the machine or its components, carried out without prior written authorization by Ghidini, relieve the latter of any responsibility and annuls any warranty obligation. The components subject to normal wear and the perishable ones are not under warranty, as well as everything which has not been previously and explicitly indicated, or damages or expenses arising from defects of the same product.

The validity conditions of the guarantee provided by Ghidini are considered implicitly accepted upon purchase of the machine. Any possible changes to or derogations from the present guarantee are only valid prior written authorization by Ghidini.

17 CONFORMITY DECLARATION

Manufacturer:

GHIDINI
Company

Via Tolstoj, 24 – 20098 S. Giuliano Milanese (MI)
Address

+39 -02 -98.24.06.00
Phone number

Declares that:

The machine:

Ironing unit PUFFER

- * has been designed in compliance with the DIRECTIVES OF THE EUROPEAN COMMUNITY COUNCIL referring to machines (98/37/EC) and to low voltage (BT 73/23/EEC).
- * has been designed, as far as enforceable, in compliance with the following harmonized regulations and technical specifications:
EN 292-1/2, EN 1050, EN 982, EN 11200, EN 60947, EN 894-1/2.

Managing director

Roland Fleischmann

Product manager

Name

GHIDINI S.R.L.

Company



May 2004

Signature

Date



Web site: <http://www.ghidini-gb.it> - E-mail: sales@ghidini-gb.it